

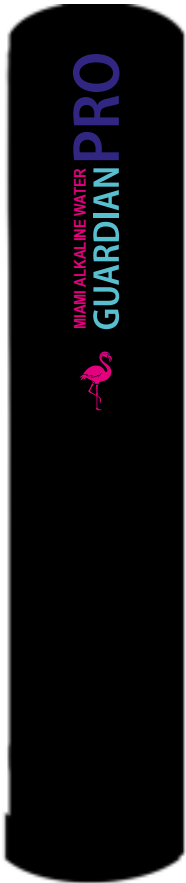

MIAMI ALKALINE WATER GUARDIAN PRO

Pro Clean Catalytic Carbon Series

INSTALLATION & SERVICE MANUAL



SAFETY GUIDE 3 PROPER INSTALLATION 3 SYSTEM DIMENSIONS 4
SPECIFICATIONS 4 BEFORE STARTING INSTALLATION 4 INSTALL BYPASS TO THE
FILTER 5 INSTALLATION INSTRUCTIONS 5 INSTALLATION 7 TROUBLE SHOOTING 8

2

SAFETY GUIDE

For your safety, the information in this manual must be followed to minimize the risk of electric shock, property damage or personal injury.

- s Check and comply with your provincial / state and local codes. You must follow these guidelines.
- s Use care when handling the filter tank. Do not turn upside down, drop, drag or set on sharp protrusions.
- s **WARNING:** This system is not intended for treating water that is microbiologically unsafe or

of unknown quality without adequate disinfection before or after the system.

PROPER INSTALLATION

This water filter system must be properly installed and located in accordance with the Installation Instructions before it is used.

- s **DO NOT** install or store where it will not be exposed to temperatures below freezing or exposed to any type of weather. Water freezing in the system will break it. Do not attempt to treat water over 100°F.
- s **DO NOT** install in direct sunlight. Excessive sun or heat may cause distortion or other damage to non-metallic parts.
- s Properly ground to conform with all governing codes and ordinances.
- s state and federal codes.
- s Maximum allowable inlet water pressure is 125 psi. If daytime pressure is over 80 psi, night time pressure may exceed the maximum. Use a pressure reducing valve to reduce the flow if necessary.
- s **WARNING:** Discard all unused parts and packaging material after installation. Small parts remaining after the installation could be a choke hazard.

C



A

- s Use only *lead-free solder and flux* for all sweat-solder connections, as required by

B

SPECIFICATIONS

How Your Filter Works

These systems are complete, self-contained, loaded with media and ready to use. A simple inlet and outlet connection is all that is required for installation. Please review operating pressures, temperatures and water chemistry limitations to ensure compatibility.

SPECIFICATIONS	PCC10	PCC15	PCC20	PCC30
Peak Flow Rate	7.0 GPM	10.0 GPM	14.0 GPM	21.0 GPM
Filter Media Volume (Cubic Feet)	1.0ft³	1.5ft³	2ft³	3ft³
Filter Tank Size	9x48	10x54	12x52	14x65
Plumbing Connections	3/4" through 1.5"			
Electrical Requirments	None			
Water Pressure	Max 125 PSI			

BEFORE STARTING INSTALLATION

Tools, Pipe, and Fittings, Other Materials

These systems are complete, self-contained, loaded with media and ready to use. A simple inlet and outlet connection is all that is required for installation. Please review operating pressures, temperatures and water chemistry limitations to ensure compatibility.

- s Pliers.
- s Screwdriver
- s Teflon tape
- s Razor knife
- s Two adjustable wrenches
- s Additional tools may be required if modification to home plumbing is required.

4

- s Plastic inlet and outlet fittings are included with the filter. To maintain full valve flow, 3/4" or 1" pipes to and from the filter fittings are recommended. You should maintain the same, or larger, pipe size as the water supply pipe, up to the filter inlet and outlet.
- s Use copper, brass, or PEX pipe and fittings.

s Some codes may also allow PVC plastic pipe.

s ALWAYS install the included bypass valve, or 3 shut-off valves. Bypass valves let you turn off water to the filter for repairs if needed, but still have water in the house pipes.

Where To Install The Filter

- s Place the filter tank as close as possible to the pressure tank (well system) or water meter (city water).
- s Connect the filter to the main water supply pipe BEFORE the water heater. DO NOT RUN HOT WATER THROUGH THE FILTER. Temperature of water passing through the filter must be less than 100 deg. F
- s Do not install the filter in a place where it could freeze. Damage caused by freezing is not covered by the warranty.

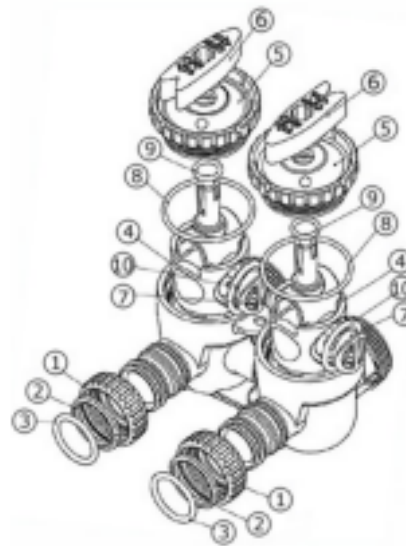

INSTALL BYPASS TO THE FILTER

- s Put the filter in a place where water damage is least likely to occur if a leak develops. The manufacturer will not repair or pay for water damage.
- s If installing in an outside location, you must take the steps necessary to assure the filter, installation plumbing, wiring, etc., are as well protected from the elements, contamination, vandalism, etc., as when installed indoors.
- s Keep the filter out of direct sunlight. The sun's heat may soften and distort plastic parts.



INSTALLATION INSTRUCTIONS

1. If your hot water tank is electric, turn off the power to it to avoid damage to the element in the tank.
2. If you have a private well, turn the power off to the pump and then shut off the main water shut off valve. If you have municipal water, simply shut off the main valve. Go

NOTE

**Be sure to use
silicone
grease on the O-rings**

to the faucet, (preferably on the lowest floor of the house) turn on the cold water until all pressure is relieved and the flow

3. Connect the inlet and outlet of the filter using appropriate fittings.

Perform all plumbing according to local plumbing codes.

- ON COPPER PLUMBING SYSTEMS BE SURE TO INSTALL A GROUNDING WIRE BETWEEN THE INLET AND OUTLET PIPING TO MAINTAIN GROUNDING.

The Inlet and Outlet should be as per below

illustration. this will ensure that water will flow through the filter under upflow configuration

Any solder joints near the valve must be done before connecting any piping to

The Inlet and Outlet should be as per below illustration. This will ensure that water will flow through the filter in an upflow configuration

5

4. Place the unit in the bypass position. Slowly

the valve. Always leave at least 6" (152 mm) between the valve and joints when soldering pipes that are connected to the valve. Failure to do this could cause damage to the valve.

turn on the main water supply. At the nearest cold treated water tap nearby remove the faucet screen, open the faucet and let water run a few minutes or until the system is free of any air or foreign material resulting from the plumbing work.

5. Make sure there are no leaks in the plumbing system before proceeding. Close the water tap when water runs clean.

6. Proceed to start up instructions. *Note: The unit is not ready for service until you complete the start-up instructions. Note : Carbon filters only:*

Once the unit has filled sufficiently that water is at least equal to the height of the media shut down the water for 15 – 20 minutes for the carbon to soak. After the carbon has soaked for the recommended time continue with installation instructions.

Additional information for Non backwashing carbon filter.

After soaking, remove the aerator screen from the nearest faucet, run water at this faucet

until all fines (black) is gone from the water. **Care of Your System**

To retain the attractive appearance of your new water filter, clean occasionally with mild soap

solution. Do not use abrasive cleaners, ammonia or solvents. Never subject your filter to freezing or to temperatures above 100°F.

Replacing the Media Bed

Carbon Filter - under normal operating conditions the effective life of the filter media is approximately one to three years, depending on the water quality, after which, taste and odor problems may return. When this happens, contact your dealer for a replacement media bed. Check to ensure all media parts are received.

The first step in replacing the media bed is to shut off the water supply to the filter. At this point, you must disconnect the plumbing from the inlet and outlet. Then unscrew the head from the fiberglass tank. Once this has been done, remove the distributor tube. Then you can remove the filter media and two types of gravel from the tank. The quickest way to do this is by simply tipping the tank upside down into a large drum or pail.

Loading the Media Pak

Place the distributor tube back down the center of the tank. NOTE: the top of this tube should be plugged with a rag or cork to prevent media from entering. Pour the bag of coarse gravel into the tank, and then pour the bag of fine gravel into the tank.

It is important that the distributor tube is not moved or pulled out as it is not possible to put it down to the bottom of the tank once gravel or media are in the tank.

Riser
Tube

Plug
the

- a) Remove the adaptor from the mineral tank. Grease the bottom oring of the adaptor.

6

The riser
(distributor)
remains inside the
tank seated in the
depression at the
bottom

b)Temporarily plug the open end of the riser tube to ensure that no resin or gravel falls down into the distributor. The riser (distributor) remains inside the tank seated in the depression at the bottom.

Plug tube with a tape. Remove after media is loaded.

c) Fill support bed first.

The media will not always spill down inside the tank and may need to be swept inside.

The large funnel (sold separately makes filling the tank easier and neater. (Or an empty 1 gallon or 4 liter container with the bottom cut out makes a good funnel.)

INSTALLATION

Electrical Panel

Raw Water

Water Meter
Ground Strap
Cold Soft Water

Hot Soft Water Ground Strap

Filtered Water

Drain

Filter Softener Water Heater



TROUBLE SHOOTING

A. FILTER BLEEDS TASTE AND ODOR OR SEDIMENT	1. By-pass valve open.	Close by-pass valve.
	2. Defective or stripped media bed	Replace media
	3. Quality of water has worsened	Have water sample analyzed to determine any change
	4. Filter capacity too small	Replace with larger unit or add a filter
	5. Leak between valve and central tube.	Check if central tube is cracked o-ring is damaged. Replace faulty parts.
B. LOW WATER PRESSURE		
B. LOW WATER PRESSURE	1. Iron or scale build up in line feeding unit.	Clean pipes.
	2. Inlet of control plugged due to foreign material.	Clean control valve.

8